

WOODLAWN DRIVE AT CLAXTON DAIRY ROAD ROUNDABOUT
PREPARED FOR:

THE CITY OF DUBLIN, GEORGIA

T&H PROJECT NO.
J-30848.0001

ADDENDUM NO. 1

January 27, 2026

GENERAL

This Addendum has been issued on behalf of the City of Dublin. The following information should be considered by prospective bidders in preparation of their proposals and is hereby incorporated into the Proposal Documents. Bidders shall be responsible for acknowledging receipt of this addendum in the Bid Form, Document 00313. Failure to do so will result in the proposal being considered non-responsive.

PART I – QUESTIONS AND CLARIFICATIONS:

A. QUESTIONS:

Question 1: What is to be included in the lump sum "Lighting" pay item? The lighting plans don't show the details nor layout typically provided with lighting plans.

Answer: *Lighting pay item is intended to be an allowance amount for Georgia Power to install lighting. Lighting is included in bid form but work to be performed by Georgia Power. Pay item will be revised for clarity.*

Question 2: What is to be included in the lump sum "Irrigation" pay item? The plans do not show any details nor layout for the irrigation?

Answer: *Contractor to install drip irrigation along with central island landscaping. Contractor to coordinate with City for location during construction. Pay item will be revised for clarity.*

Question 3: The grading cross sections only include the road alignments leading up to the roundabout but do not include the roundabout. Please provide cross sections or Existing and Design contour lines for the roundabout area that is missing from the cross sections.

Answer: *See sheets 18-0001 and 18-0002 for Special Grading sheets and grading points.*

Question 4: Will construction phasing plans be issued for this project? This will be very useful in bidding process?

Answer: *As stated on sheet 04-0001 Note #30, Contractor shall submit staging plans to City and Engineer for approval.*

Question 5: Will you be able to send us an AutoCAD file for this project? We were looking for something to help us quantify the earthwork.

Answer: *DGN files can be provided. Please coordinate with Karen Smulski at Smulski.k@tandh.com to receive files.*

Question 6: How will temporary asphalt paving and asphalt leveling be paid for if required by the approved phasing plan?

Answer: ***As stated on sheet 04-0001 Note #28, any temporary paving required to facilitate the construction of the job shall be included in the lump sum bid for traffic control.***

PART II – CONTRACT DOCUMENTS AND TECHNICAL SPECIFICATIONS:

The Proposal Documents shall be changed in the following respects:

SECTION 0002 – CONTENTS

1. Delete and replace with the attached Section 0002 – “Contents”.

SECTION 0021 – INVITATION TO BID

The Invitation to Bid was amended to include the following:

1. The City of Dublin, in accordance with Title VI of the Civil Rights Act of 1964, 78 Stat. 252, 42 U.S.C. 2000d to 2000d-4 and Title 49, Code of Federal Regulations, Department of Transportation, Subtitle A, Office of the Secretary, Part 21, Nondiscrimination in Federally-assisted programs of the Department of Transportation issued pursuant to such Act, hereby notifies all bidders that it will affirmatively ensure that in any contract entered into pursuant to this advertisement, disadvantaged business enterprises as defined at 49 CFR Part 23 will be afforded full opportunity to submit bids in response to this invitation and will not be discriminated against on the grounds of race, color, national origin, or sex in consideration for an award.

SECTION 00313 – BID FORM

2. Delete and replace with the attached Section 00313 – “Bid Form”.
3. Bidders must use the enclosed form. **NO OTHER FORM SHALL BE ACCEPTED.**

SECTION 00710 – SPECIAL CONDITIONS

The Special Conditions was amended to include the following:

1. **CONTRACTOR WORK SUMMARY:** Contractor shall include a summary of work performed during the applicable billing period when submitting pay applications. This summary shall include details of requested weather days or delays incurred along with the latest construction schedule. Additional documentation and information may be required with pay application submittals at the discretion of the Engineer.

SECTION 01742 – NON-DISCRIMINATION AGREEMENT

1. Non-discrimination agreement added to specifications.

PART III – DRAWINGS:

1. The drawings have been revised to include revisions to the utility plan and typical sections.
Delete and replace with the attached plan sheets.

THOMAS & HUTTON



Corey Cook, PE
Project Manager

End of ADDENDUM NO. 1

TABLE OF CONTENTS

PAGE NUMBERS

CONTRACT DOCUMENTS

| | | | | |
|-------|---------------------------------------------------------|---------|---|----------|
| 00021 | Invitation to Bid | 00021-1 | - | 00021-2 |
| 00110 | Instructions to Bidders | 00110-1 | - | 00110-8 |
| 00313 | Bid Form | 00313-1 | - | 00313-6 |
| 00411 | Bid Bond | 00411-1 | - | 00411-2 |
| 00506 | Standard Form of Agreement Between Owner and Contractor | 00506-1 | - | 00506-7 |
| 00611 | Performance Bond | 00611-1 | - | 00611-6 |
| 00621 | Payment Bond | 00621-1 | - | 00621-6 |
| 00631 | Notice of Award | 00631-1 | - | 00631-2 |
| 00641 | Notice to Proceed | 00641-1 | - | 00641-2 |
| 00700 | General Conditions | 00700-1 | - | 00700-62 |
| 00710 | Special Conditions | 00710-1 | - | 00710-6 |
| 00815 | Supplementary Conditions | 00815-1 | - | 00815-5 |
| 01011 | Summary of Work | 01011-1 | - | 01011-3 |
| 01025 | Measurement and Payment | 01025-1 | - | 01025-2 |
| 01300 | Submittals | 01300-1 | - | 01300-6 |
| 01400 | Quality Control | 01400-1 | - | 01400-4 |
| 01410 | Testing Services | 01410-1 | - | 01410-4 |
| 01702 | Contract Closeout | 01702-1 | - | 01702-4 |
| 01730 | Operation and Maintenance | 01730-1 | - | 01730-4 |
| 01740 | Warranties | 01740-1 | - | 01740-2 |
| 01741 | Bonds | 01741-1 | - | 01741-2 |
| 01742 | Non-Discrimination Agreement | 01742-1 | - | 01742-2 |

TECHNICAL PROVISIONS

All technical specifications and details shall be in accordance with Georgia Department of Transportation standards unless otherwise noted.

DOCUMENT 00021
INVITATION TO BID
Legal Notice

1. Sealed proposals for **Woodlawn Drive and Claxton Dairy Road Roundabout** owned by The City of Dublin, Georgia will be received by Matthew Bradshaw at the City of Dublin Engineering office, located at 100 South Church Street, Dublin, Georgia 31021 until **2:00 PM on Thursday, February 5th 2026**, at which time they will be publicly opened.

2. The project consists of the following generally described work:

The project consists of a roundabout constructed at the intersection of Woodlawn Drive and Claxton Dairy Road in Dublin, Georgia. The proposed roundabout will be single lane with concrete splitter islands on each approach. Other work includes new median, new striping, and landscaping. Roundabout is to follow the Georgia Department of Transportation standard specifications and details.

3. Plans and Specifications are open to inspection at the City of Dublin Engineering office, located at 100 South Church Street, Dublin, Georgia 31021, or may be obtained from Thomas & Hutton Engineering Co., 50 Park of Commerce, Savannah, Georgia 31405 upon payment of \$50.00 (half size) or \$100.00 (full size) plus a pdf copy. The contractor may request a PDF copy only upon payment of \$25.00. The payment is non-refundable. Contact Karen Smulski at Thomas & Hutton via email smulski.k@tandh.com to request copies.

4. Bids shall be accompanied by a bid bond or certified cashier's check in an amount not less than 10% of the base bid. All bonds shall be by a surety company licensed in **Georgia** with an "A" minimum rating of performance and a financial strength of at least five times the contract price as listed in the most current publication of "Best's Key Rating Guide Property Liability." Performance and Payment Bonds, each in an amount equal to 100% of the contract price shall be required of the successful bidder if contract is awarded. Each Bond shall be accompanied by a "Power of Attorney" authorizing the attorney-in-fact to bind the surety and certified to include the date of the bond.

5. Owner reserves the right to reject any or all Bids, including without limitation, the rights to reject any or all nonconforming, nonresponsive, unbalanced or conditional Bids and to reject the Bid of any Bidder if Owner believes it would not be in the best interest of the Project to make an award to Bidder, whether because the Bid is not responsive or the Bidder is unqualified or of doubtful financial ability or fails to meet any other pertinent standard or criteria established by the Owner.

6. *The City of Dublin, in accordance with Title VI of the Civil Rights Act of 1964, 78 Stat. 252, 42 U.S.C. 2000d to 2000d-4 and Title 49, Code of Federal Regulations, Department of Transportation, Subtitle A, Office of the Secretary, Part 21, Nondiscrimination in Federally-assisted programs of the Department of Transportation issued pursuant to such Act, hereby notifies all bidders that it will affirmatively ensure that in any contract entered into pursuant to this advertisement, disadvantaged business enterprises as defined at 49 CFR Part 23 will be afforded full opportunity to submit bids in response to this invitation and will not be discriminated against on the grounds of race, color, national origin, or sex in consideration for an award.*

7. A pre-bid conference will be held at the City of Dublin Engineering office at 2 PM on Thursday, January 15th, 2026. All questions shall be submitted in writing to Engineer by Friday, January 23rd, 2026, at 5:00 PM. An addendum addressing all questions and comments received by the question deadline will be issued via electronic mail by end of business on Thursday, January 29th, 2026.

ENGINEER

Thomas & Hutton
Attn: Doyle Kelley, P.E.
50 Park of Commerce Way
Savannah, GA 31405
Phone: 912-721-4160
Email: kelly.d@tandh.com

OWNER

City of Dublin
Attn: Matthew Bradshaw
100 South Church Street
Dublin, GA 31021
Phone: 478-277-5068
Email: bradshawm@dublinga.com

City of Dublin, Georgia, Owner

END OF INVITATION TO BID

DOCUMENT 00313**BID FORM**

PROJECT IDENTIFICATION: Woodlawn Drive and
Claxton Dairy Road Roundabout

**CONTRACT IDENTIFICATION
AND NUMBER:** J -30848.0000

THIS BID IS SUBMITTED TO: City of Dublin Engineering

1. The undersigned BIDDER proposes and agrees, if this Bid is accepted, to enter into an agreement with OWNER in the form included in the Contract Documents to perform and furnish all Work as specified or indicated in the Contract Documents for the Bid Price and within the Bid Times indicated in this Bid and in accordance with the other terms and conditions of the Contract Documents.
2. BIDDER accepts all of the terms and conditions of the Advertisement or Invitation to Bid and Instructions to Bidders, including without limitation those dealing with the disposition of Bid security. This Bid will remain subject to acceptance for 90 days after the day of Bid opening, or for such longer period of time BIDDER may agree to in writing upon request of OWNER.
3. In submitting this Bid, BIDDER represents, as more fully set forth in the Agreement, that:
 - a. BIDDER has examined and carefully studied the Plans and Specifications for the work and contractual documents related thereto, and has read all Technical Provisions, Supplementary Conditions, and General Conditions, furnished prior to the opening of Bids and can fulfill the requirements of the work to be performed.
 - b. BIDDER further acknowledges hereby receipt of the following Addenda:

| ADDENDUM NO. | DATE |
|--------------|------------|
| 1 | 01/27/2026 |
| | |

- c. BIDDER has visited the site and become familiar with and is satisfied as to the general, local and site conditions possibly affecting cost, progress, performance and furnishing of the Work;
 - d. BIDDER is familiar with and is satisfied to all federal, state, and local Laws and Regulations possibly affecting cost, progress, performance and furnishing of the Work.
 - e. BIDDER has carefully studied all reports of explorations and tests of subsurface conditions at or contiguous to the site and all drawings of physical conditions in or relating to existing surface or subsurface structure at or contiguous to the site

(except underground Facilities) have been identified in the Supplementary Conditions. BIDDER acknowledges such reports and drawings are not Contract Documents and may not be complete for BIDDER's purposes. BIDDER acknowledges OWNER and Engineer do not assume responsibility for the accuracy or completeness of information and data shown or indicated in the Bidding Documents with respect to Underground Facilities at or contiguous to the site. BIDDER has obtained and carefully studied (or assumes responsibility for having done so) all such additional or supplementary examinations, investigations, explorations, tests, studies and data concerning conditions (surface, subsurface and Underground Facilities) at or contiguous to the site or otherwise which may affect cost progress, performance or furnishing of the work or which relate to any aspect of the means, methods, techniques, sequences and procedures of construction to be employed by BIDDER and safety precautions and programs incident thereto. BIDDER does not consider any additional examinations, investigations, explorations, tests, studies, or data are necessary for the determination of this Bid for performance and furnishing of the Work in accordance with the times, price and other terms and conditions of the Bidding Documents.

- f. BIDDER is aware of the general nature of Work to be performed by Owner and others at the site relating to Work for which this Bid is submitted as indicated in the Bidding Documents.
 - g. BIDDER has correlated the information known to BIDDER, information and observations obtained from visits to the site, reports and drawings identified in the Bidding Documents and all additional examinations, investigations, explorations, tests, studies, and data with the Bidding Documents.
 - h. BIDDER has given ENGINEER written notice of all conflicts, errors, ambiguities, or discrepancies BIDDER has discovered in the Bidding Documents and the written resolution thereof by ENGINEER is acceptable to BIDDER. The Bidding Documents are generally sufficient to indicate and convey understanding of all terms and conditions for performing and furnishing the Work for which this Bid is submitted.
 - i. This bid is genuine and not made in the interest of or on behalf of any undisclosed person, firm or corporation and is not submitted in conformity with any agreement or rules of any group, association, organization or corporation; BIDDER has not directly or indirectly induced or solicited any other Bidder to submit a false or sham Bid; BIDDER has not solicited or induced any person, firm or corporation to refrain from bidding; and BIDDER has not sought by collusion to obtain for itself any advantage over any other Bidder or over OWNER.
4. BIDDER will complete the Work in accordance with the Contract Documents for the following price(s):

| WOODLAWN DRIVE AND CLAXTON DAIRY ROAD ROUNDABOUT | | | | | |
|--------------------------------------------------|------------------------------------------------------------------------|----------|---------|----------|------------|
| ITEM | DESCRIPTION | QUANTITY | | COST | |
| | | UNITS | MEASURE | PER UNIT | TOTAL COST |
| ROADWAY CONSTRUCTION | | | | | |
| 150-1000 | Traffic Control | 1 | LS | | \$ - |
| 151-1000 | Mobilization | 1 | LS | | \$ - |
| 163-0232 | Temporary Grassing | 4 | AC | | \$ - |
| 163-0240 | Mulch | 38 | TN | | \$ - |
| 163-0301 | Construct and Remove Construction Exits | 2 | EA | | \$ - |
| 163-0550 | Construct and Remove Inlet Sediment Trap | 32 | EA | | \$ - |
| 165-0010 | Maintenance of Temporary Silt Fence, Type A | 2,900 | LF | | \$ - |
| 165-0101 | Maintenance of Construction Exits | 2 | EA | | \$ - |
| 165-0105 | Maintenance of Inlet Sediment Traps | 32 | EA | | \$ - |
| 167-1000 | Water Quality Monitoring and Sampling | 1 | EA | | \$ - |
| 167-1500 | Water Quality Inspections | 9 | MO | | \$ - |
| 171-0010 | Temporary Silt Fence, Type A | 2,900 | LF | | \$ - |
| 205-0001 | Unclass Excav | 200 | CY | | \$ - |
| 207-0203 | Found Bkfill Matl, Tp 2 | 160 | CY | | \$ - |
| 210-0100 | Grading Complete | 1 | LS | | \$ - |
| 310-5080 | Gr Aggr Base Crs, 8 Inch, Incl Material | 2,500 | SY | | \$ - |
| 402-1812 | Recycled Asph Conc Leveling, Inc Bitum Matl & H Lime | 600 | TN | | \$ - |
| 402-3130 | Aph Conc 12.5 MM Superpave, GP 2 Only, Incl Bitum Matl & H Lime (1.5") | 900 | TN | | \$ - |
| 402-3190 | Asph Conc 19mm Superpave, GP 1 or 2, Incl Bitum Matl & H Lime (2") | 200 | TN | | \$ - |
| 413-0750 | Tack Coat | 900 | GL | | \$ - |
| 432-0206 | Mill Asph Conc Pvmt, 1 1/2 Inch Depth | 800 | SY | | \$ - |
| 439-0022 | Plain PC Conc Pvmt, CL 3 Conc, 10 Inch Thk | 800 | SY | | \$ - |
| 441-0104 | Conc Sidewalk, 4 In | 900 | SY | | \$ - |
| 441-0748 | Concrete Median, 6 In | 600 | SY | | \$ - |
| 441-5001 | Concrete Header Curb, 4 in, TP 1 | 200 | LF | | \$ - |
| 441-5004 | Concrete Header Curb, 10 in, TP 4 | 92 | LF | | \$ - |
| 441-5025 | Concrete Header Curb, 4 In, TP 9 | 400 | LF | | \$ - |
| 441-6222 | Conc Curb & Gutter, 8in X 30in, TP 2 | 2,400 | LF | | \$ - |

| | | | | | |
|----------|-----------------------------------------------|-------|-----|--|------|
| 441-6745 | Conc Curb & Gutter, 8in X 32in, TP 9 | 300 | LF | | \$ – |
| 446-1100 | Pvmt Reinf Fabric Strips, TP2, 18 Inch Width | 800 | LF | | \$ – |
| 500-9999 | Class B Conc, Base or Pvmt Widening | 100 | CY | | \$ – |
| 550-5180 | Storm Drain Pipe, 18 In, Class III | 155 | LF | | \$ – |
| 550-5240 | Storm Drain Pipe, 24 In, Class III | 270 | LF | | \$ – |
| 550-5360 | Storm Drain Pipe, 36 In, Class III | 185 | LF | | \$ – |
| 550-5480 | Storm Drain Pipe, 48 In, Class III | 290 | LF | | \$ – |
| 611-8050 | Adjust Manhole to Grade | 8 | EA | | \$ – |
| 634-1200 | Right Of Way Markers | 14 | EA | | \$ – |
| 636-1033 | Highway Signs, TP1 Matl, Refl Sheeting, TP9 | 25 | SF | | \$ – |
| 636-1036 | Highway Signs, TP1 Matl, Refl Sheeting, TP11 | 175 | SF | | \$ – |
| 636-1041 | Highway Signs, TP2 Matl, Refl Sheeting, TP9 | 175 | SF | | \$ – |
| 636-2070 | Galv Steel Posts, TP7 | 910 | LF | | \$ – |
| 653-0130 | Thermoplastic Pvmt Marking, Arrow, TP 3 | 4 | EA | | \$ – |
| 653-0296 | Thermoplastic Pvmt Marking, Word, TP 15 | 4 | EA | | \$ – |
| 653-1804 | Thermoplastic Solid Traf Stripe, 8 In, White | 2,330 | LF | | \$ – |
| 653-1906 | Thermoplastic Solid Traf Stripe, 6 In, White | 3,315 | LF | | \$ – |
| 653-2602 | Thermoplastic Solid Traf Stripe, 6 In, Yellow | 4,690 | LF | | \$ – |
| 653-4830 | Thermoplastic Skip Traf Stripe, 18 In, White | 100 | GLF | | \$ – |
| 653-6006 | Thermoplastic Traf Striping, Yellow | 460 | SY | | \$ – |
| 668-2100 | Drop Inlet, GP 1 | 15 | EA | | \$ – |
| 668-4300 | Storm Sewer Manhole, TP1 | 3 | EA | | \$ – |
| 668-5000 | Junction Box | 1 | EA | | \$ – |
| 668-7018 | Drain Inlet, 18 In | 3 | EA | | \$ – |
| 700-6910 | Permanent Grassing | 2.00 | AC | | \$ – |
| 700-7000 | Agricultural Lime | 6.00 | TN | | \$ – |
| 700-8000 | Fertilizer Mixed Grade | 2.00 | TN | | \$ – |
| 700-8100 | Fertilizer Nitrogen Content | 80 | LB | | \$ – |
| 1005 | Install 1" PVC Line, Service Line, and Meter | 1 | LS | | \$ – |
| 1010 | Adjust Gas Valves | 2 | EA | | \$ – |
| 1015 | Adjust Water Valves | 2 | EA | | \$ – |
| 1020 | Lighting Allowance | 1 | LS | | \$ – |
| 1025 | Red Maple 15 gal | 4 | EA | | \$ – |

| | | | | | |
|---------------------------------|------------------------------|----|----|--|-----------|
| 1026 | Green Velvet Boxwood 3 gal. | 50 | EA | | \$ – |
| 1027 | Emerald Sod 2 pallets | 2 | EA | | \$ – |
| 1028 | Flats of Annual Color | 25 | EA | | \$ – |
| 1029 | Bales of Straw | 50 | EA | | \$ – |
| 1030 | Steel Edging | 1 | LS | | \$ – |
| 1031 | Irrigation (Drip with Timer) | 1 | LS | | \$ – |
| 1032 | Labor to Landscape | 1 | LS | | \$ – |
| 1033 | Landscape Fabric and Staples | 1 | LS | | \$ – |
| 1034 | Relocate Fire Hydrant | 1 | EA | | \$ – |
| Sub-Total, ROADWAY CONSTRUCTION | | | | | \$ – |
| TOTAL PROJECT | | | | | \$ |

TOTAL BID:

_____ Dollars

\$ _____

Unit Prices have been computed in accordance with paragraph 11.03.C of the General Conditions.

BIDDER acknowledges estimated quantities are not guaranteed and are solely for the purpose of comparison of Bids, and final payment for all Unit Price Bid items will be based on actual quantities determined as provided, determined as provided in the Contract Documents.

5. BIDDER agrees the Work will be substantially complete within 270 calendar days after the date when the Contract Times commence to run as provided in paragraph 2.03 of the General Conditions and completed and ready for final payment in accordance with paragraph 14.07 of the General Conditions within 300 calendar days after the date when the Contract Times commence to run.
6. BIDDER accepts provisions of the Agreement as to liquidated damages in the event of failure to complete the Work within times specified in the Agreement.
7. The following documents are attached to and made a condition of this Bid:
 - a. Required Bid Security in the form of 10 percent of the Bid Total Price.
8. The undersigned further agrees in case of failure on his/her part to execute the said contract and the Bond within 30 consecutive calendar days after written notice being given of the award of the contract, the check or bid bond accompanying this bid, and the monies payable thereon shall be paid into the funds of the Owner as liquidated damages for such failure, otherwise, the check or bid bond accompanying this proposal shall be returned to the undersigned.

9. Communications concerning this Bid shall be addressed to:

Doyle D. Kelley, P.E.
Thomas & Hutton
50 Park of Commerce Way
Savannah, GA 31405
(912)721-4160
kelley.d@tandh.com

10. Terms used in this Bid which are defined in the General Conditions or Instructions will have the meanings indicated in the General Conditions of Instructions.

SUBMITTED _____ 2026.

CONTRACTOR'S NAME

ADDRESS:

BY: _____

State Contractor License No. _____

DOCUMENT 00710**SPECIAL CONDITIONS**

SC-1 DESCRIPTION OF THE WORK: The project consists of a roundabout constructed at the intersection of Woodlawn Drive and Claxton Dairy Road in Dublin, Georgia. The proposed roundabout will be single lane with concrete splitter islands on each approach. Other work includes new median, new striping, and landscaping. Roundabout is to follow the Georgia Department of Transportation standard specifications and details.

SC-2 COMMENCEMENT AND COMPLETION OF WORK: The Contractor shall commence work within 10 days after Notice to Proceed is issued. Work shall be completed within 300 calendar days.

If the Contractor fails to prosecute the work with such diligence as will insure the completion of each portion of the work within the time shown on the above schedule, plus any extensions made in accordance with Article 12 of the General Conditions; and, if the Owner does not exercise reservations as set forth in Article 13 of the General Conditions, the Contractor shall continue the work in which event liquidated damages for the delay will be impossible to determine. In lieu, thereof, liquidated damages in the amount of \$1,000.00 per each day of delay of the work until the work is completed.

8.1 **SC-3 DRAWINGS:** The work shall conform to the following drawings, all of which form a part of, and are included in, these specifications and are available in the office of Thomas & Hutton Engineering Co., 50 Park of Commerce Way, Savannah, Georgia 31405. following general sections:

| Section | Description | Job No. |
|----------------|------------------------------------------------------|----------------|
| 01 | Cover Drawing | 30848.0000 |
| 02 | Index Drawing | 30848.0000 |
| 04 | General Notes/Project Notes | 30848.0000 |
| 05 | Typical Sections | 30848.0000 |
| 11 | Construction Layout Drawing (Stakeout Drawing) | 30848.0000 |
| 13 | Mainline Roadway, Crossroad, and Side Street | 30848.0000 |
| 15 | Mainline Roadway Profile Drawings | 30848.0000 |
| 16 | Crossroad Profile Drawings | 30848.0000 |
| 17 | Driveway Profiles | 30848.0000 |
| 18 | Special Grading | 30848.0000 |
| 21 | Drainage Area Map | 30848.0000 |
| 22 | Drainage Profiles | 30848.0000 |
| 23 | Cross Sections | 30848.0000 |
| 24 | Utility Plans | 30848.0000 |
| 25 | Lighting Plans | 30848.0000 |
| 26 | Signing and Marking Plan and Details – Plan Drawings | 30848.0000 |
| 44 | Utility Relocation Plans | 30848.0000 |
| 50 | ESPCP Cover Sheet | 30848.0000 |
| 51 | ESPCP General Notes | 30848.0000 |

| Section | Description | Job No. |
|---------|------------------------------------------|------------|
| 53 | ESPCP Drainage Area Map | 30848.0000 |
| 54 | ESPCP BMP Location Details | 30848.0000 |
| 55 | ESPCP Watershed Map Site Monitoring Plan | 30848.0000 |

SC-4 LAYOUT OF WORK: Control lines and master benchmarks will be furnished by the Owner. The contractor will lay out work and will be responsible for all measurements in connection therewith.

SC-5 OBSERVATIONS AND TESTS: Before acceptance of the whole or any part of the work, it shall be subjected to observation and tests to determine it is in accordance with the plans and specifications. The Contractor will be required to maintain all work in a first-class condition for a 30-day operating period after the same has been completed as a whole and the Engineer has notified the Contractor in writing the work has been finished. The Owner shall pay for all testing and shall engage a GDOT acceptable laboratory or qualified individual to conduct the tests in accordance with these specifications. No portion of the work will be accepted until tests prove it has been satisfactorily completed. The Contractor shall give the Project Engineer or Project Representative a minimum of 48 hours notice for all required observations or tests.

SC-6 BONDS: The Performance Bonds in the amount of 100% of the contract amount and Payment Bonds in the amount of 100% of the contract amounts shall be furnished in accordance with Article 5 of the General Conditions.

SC-7 CONTRACTOR'S AND SUBCONTRACTOR'S INSURANCE: The Contractor shall not commence work under this contract until obtaining all the insurance required under this paragraph and such insurance has been accepted by the Owner, nor shall the Contractor allow any Subcontractor to commence work on a subcontract until the insurance required of the Subcontractor has been so obtained and accepted.

- a. Compensation and Employer's Liability Insurance: The Contractor shall take out and maintain during the life of the contract the statutory Worker's Compensation and Employer's Liability Insurance for all of its employees to be engaged in work on the project under the contract and, in case and such work is sublet, the Contractor should require the Subcontractor similarly to provide Worker's Compensation and Employer's Liability Insurance for all the latter's employees to be engaged in such work.
- b. Bodily Injury Liability and Property Damage Liability Insurance: The Contractor shall take out and maintain during the life of the contract Bodily Injury Liability and Property Damage Liability Insurance to protect itself and any Subcontractor performing work covered by the contract from claims for damages or personal injury, including accidental death, as well as from claims for property damage, which may arise from operations under the contract, whether such operations be by the Contractor, Subcontractor, or anyone directly or indirectly employed by either of them and the amount of such insurance should be not less than:
 - (1) Bodily Injury Liability Insurance, in an amount not less than \$1,000,000.00 for injuries, including wrongful death to any one person and subject to the same limit for each person in an amount not less

than \$2,000,000.00 on account of one accident. Contractual liability should be endorsed on the policy.

- (2) Property Damage Insurance in an amount not less than \$1,000,000.00 for damages on account of any one accident, and in an amount not less than \$2,000,000.00 for damages on account of all accidents.

- c. Builder's Risk Insurance (Fire and Extended Coverage): The Contractor shall have adequate fire and standard extended coverage, with a company or companies acceptable to the Owner, in force on the project. The provisions with respect to Builder's Risk Insurance shall in no way relieve the Contractor of its obligation of completing the work covered by the Contract.
- d. Proof of Carriage of Insurance: The Contractor shall furnish the Owner with certificates showing the type, amount, class of operations, effective dates, and date of expiration of policies. Such certificates shall contain substantially the following statement: "The insurance covered by this certification shall not be cancelled or materially altered, except after ten (10) days written notice has been received by the Owner."

SC-8 HOLD HARMLESS CLAUSE: The Contractor agrees to hold harmless, indemnify and defend the Owner and its agents, architects, engineers and employees from and against any and all claims, losses, damages, demands, causes of action and any an all related costs and expenses, of every kind and character, growing out of, incidental to, or resulting directly or indirectly from the Contractor's performance of the work described herein, whether such loss, damage, injury, or liability is contributed to by the negligence of the Owner, its agents, architects, engineers, or employees, except the Contractor shall have no liability for damages or the costs incidental thereto caused by the sole negligence of the Owner, its agents, architects, engineers, or employees. The Contractor will require any and all subcontractors to conform with the provisions of this clause prior to commencing any work and agrees to ensure this clause is in conformity with the insurance provisions of the contract.

SC-9 CONTRACTOR'S STATUS: It is agreed the Contractor shall occupy the status of an Independent Contractor and the Contractor's employees are not employees of the Owner.

SC-10 CONTRACTOR'S AFFIDAVIT: Upon completion of the work and prior to final payment and settlement of all sums due hereunder, Contractor will furnish to Owner a Contractor's Affidavit in the usual form submitted by Contractor under the laws of the State of Georgia to the effect all bills for labor, materials and services in connection with said contract have been paid in full, acknowledging receipt of the contract price and averring there are no outstanding claims under said contract which could become a lien on the real estate arising out of said contract.

SC-11 RESIDENT PROJECT ENGINEER: The Owner reserves the right to furnish a Resident Project Engineer as deemed necessary to insure the Project quality control and conformance to Plans and Specifications, who will act as the Owner's Representative on the Project and will have the authority of the Engineer as set forth in the Contract Documents.

SC-12 BARRICADES, DANGER AND WARNING SIGNS: The Contractor shall install and maintain barricades, suitable and sufficient lights, danger signals, signs, and other traffic control

devices and shall take all necessary precautions for the protection of the work and safety of the public. Lanes closed to traffic shall be protected by effective barricades, lighted during hours of darkness. Suitable warning signs shall be provided to control, direct traffic, and warn pedestrians. Upon completion all barricades, signs and the like shall be removed.

SC-13 TOOLS, PLANT AND EQUIPMENT: If at any time before the commencement or during the progress of the work, tools, plant or equipment appear to the Engineer to be insufficient, inefficient or inappropriate to secure the quality of the work required or the proper rate of progress, the Engineer may order the Contractor to increase their efficiency, to improve their character, to augment their number, or to substitute new tools, plant, or equipment, as the case may be, and the Contractor must conform to such order; but a failure of the Engineer to demand such increase of efficiency, number, or improvement shall not relieve the Contractor of its obligation to secure the quality of work and the rate of progress necessary to complete the work within the time required by the contract to the satisfaction of the Owner.

SC-14 ACCIDENTS: The Contractor shall provide, at the site, such equipment and medical facilities as are necessary to supply first-aid service to anyone who may be injured in connection with the work. The Contractor must report in writing to the Engineer all accidents whatsoever arising out of, or in connection with, the performance of the work, whether on or adjacent to the site, which causes death, personal injury or property damages, giving full details and statement of witnesses. In addition, if death or serious injuries or serious damages are caused, the accident shall be reported immediately by telephone or messenger to both the Contractor and any subcontractor on account of any accident, the Contractor shall promptly report the facts to the Engineer, giving full details in writing of the claim. The Contractor shall advise its superintendent and foreman, who are on the site of the work, the name of the hospital and phone number and the name and phone number of the doctor to use in case of an accident.

SC-15 SANITARY PROVISIONS: The Contractor shall provide temporary sanitary facilities for the use of the workmen during the progress of the work. The sanitary facilities shall conform to the requirements of the County health Engineer. All facilities shall be removed at the completion of the contract.

SC-16 MODIFICATION OF QUANTITIES: The itemized quantities shall be considered by the Contractor as the quantities required to complete the work for the purpose of bidding. Should actual quantities required in the construction of the work be greater or less than the quantities shown on the items, an amount equal to the difference in quantities at the unit prices for the item will be added to or deducted from the contract price.

When itemized quantities are not given in the Proposal, the work shown on the plans or specified shall be considered by the Contractor to be included in the contract for the lump sum prices bid.

SC-17 RESPONSIBILITY REGARDING EXISTING UTILITIES AND STRUCTURES: The existence and location of underground utilities will be investigated and verified in the field by the Contractor before starting work. The Contractor shall call for underground utility locations. Underground utilities location service can be contacted at 1-800-282-7411 (GA). The location of all known interferences based on the best information available has been shown on the drawings, but this information may not be complete. Excavation in the vicinity of existing structures and utilities shall be carefully done by hand. The Contractor shall be held responsible for any damage to and for maintenance and protection of existing utilities and structures. The

Contractor is responsible for coordinating with the utility companies any relocation, adjustment, or replacement of utility facilities.

SC-18 INTERRUPTION OF UTILITY SERVICE: The Contractor's operations shall be conducted to interfere as little as possible with utility services. Any proposed interruption by the Contractor must be accepted in advance by the Engineer.

SC-19 OMISSION: The drawings and specifications shall both be considered as a part of the contract. Any work and material shown in the one and omitted in the other or described in the one and not shown in the other, or which may fairly be implied by both or either, shall be furnished and performed as though shown in both, in order to give a complete and first class job.

SC-20 MEASUREMENT AND PAYMENT: Measurement and payment shall be made for the units and at the lump sum contract prices shown on the Bid Schedule. Direct payment shall only be made for those items or work specifically listed in the proposal and the cost of any other work must be included in the contract price for the applicable items to which it relates.

SC-21 "OR EQUIVALENT," CLAUSE: Although the plans and specifications make reference to particular manufacturers and model numbers for various products, such reference is made only to establish function and quality of such products. If it is desired to use materials or equipment of trade names or of manufacturer's names that are different from those mentioned in the contract documents, information pertaining to such items must reach the hands of the Engineer at least 10 days prior to the date set for the opening of bids. The burden of proving equality of a proposed substitute to an item designated by trade name or by manufacturer's name in the contract document rests on the party submitting the request for acceptance. The written application for review of a proposed substitute must be accompanied by technical data that the party requesting review desires to submit in support of its application. The Engineer will give consideration to reports from reputable independent testing laboratories, verified experience records showing the reputation of the proposed product with previous users or any other written information that is reasonable in the circumstances. The application to the Engineer for review of a proposed substitute must be accompanied by a schedule setting forth in what respects the material or equipment submitted for consideration differs from the materials or equipment designated in the contract documents. The degree of proof required for acceptance of a proposed substitute as equivalent to a named product is the amount of proof necessary to convince the Engineer beyond all doubt. To be acceptable, a proposed substitute must, in addition, meet or exceed all express requirements of the contract documents.

If submittal is accepted by the Engineer, an addendum will be issued to all prospective bidders at least five days prior to the date set for the opening of bids.

The Engineer shall be the final judge on questions of similarity and equality.

SC-22 SAFETY AND HEALTH REGULATIONS: The Contractor shall comply with the Department of Labor Safety and Health Regulations for Construction promulgated under the Occupational Safety and Health Act of 1970 as amended through January 1, 2004 (PL 91-596) and under Section 107 of the Contract Work and Safety Standards Act (PL 91-54). The regulations are administered by the Department of Labor and the Contractor shall allow access to the project to personnel from that Department.

SC-23 RECORD DATA AND DRAWINGS: The Contractor shall keep accurate, legible records of the locations, types, and sizes of sanitary lines, service laterals, manholes, cleanouts, water lines, fittings, valves, hydrants, drainage pipes, drainage structures, and other related work performed under this project. Where proposed and existing utilities cross, the Contractor shall measure and record the horizontal location and vertical separation between each crossing. Separation shall be measured between exteriors of pipes. On a set of project prints provided by the Owner, the Contractor shall prepare a set of "record" drawings from the data stated above. The horizontal locations of all portions of items installed on this project shall be accurately tied down to features that are physical and visible, such as property corner markers and/or permanent type structures. Invert elevations of all manholes, storm sewers and structures, sanitary sewers and lift stations shall be clearly indicated. These "record" drawings shall be kept clean and dry and maintained in a current state with the progress of the work. If at any time, a copy of this plan or portion of it is requested by the Owner, such copy shall be made available within 24 hours after the request is made.

Before final acceptance of the completed installation and final payment by the Owner, the Contractor shall deliver to the Engineer, four sets of "Record" Drawings accurately depicting the horizontal and vertical as-built data described in the above paragraph. "Record" drawings for the items installed on this project shall be certified by a licensed surveyor, other than Thomas & Hutton, registered in Georgia. The size of the drawings shall be 24" x 36". The "Record" drawings shall have a coordinate system based on the Georgia State Plane Coordinate System, East Zone, North American Datum of 1983 (NAD83). Elevations shall be based on the North American Vertical Datum of 1988 (NAVD 88). All measurements and coordinates shown shall use the U.S. Survey flood definition. Coordinates shall be shown on all drainage structures, sanitary sewer manholes, storm manholes/boxes, valve boxes/vaults, valve manholes, valves, fire hydrants, fittings, and all other related work performed under this contract. Vertical data including but not limited to, structure and manhole frame and inverts, pipe inverts, lift station frame, inverts, control levels, bottom, site grading, and as-built grading shall be shown. In addition to the "Record" drawings, Contractor shall deliver to Engineer electronic AutoCAD (v. 14 or later) files of all the data described above on a CD-ROM.

SC-24 PROPERTY CORNERS: The Contractor shall be responsible for restoring any property corners or monuments disturbed during construction. They shall be restored by a professional surveyor registered in the State of Georgia.

SC-25 VIDEO: A video showing existing site conditions shall be made by the Contractor prior to start of construction. Contractor shall provide Owner and Engineer a copy of the video. Contractor is encouraged to record any existing damaged facilities that could be questioned later by property owners. A written or recorded narrative shall be provided with the video. Engineer shall be notified 72 hours in advance making the video. Contractor is responsible for all costs associated with video and shall be considered a subsidiary part of the contract.

SC-26 CONTRACTOR WORK SUMMARY: Contractor shall include a summary of work performed during the applicable billing period when submitting pay applications. This summary shall include details of requested weather days or delays incurred along with the latest construction schedule. Additional documentation and information may be required with pay application submittals at the discretion of the Engineer.

END OF SECTION

DOCUMENT**NON-DISCRIMINATION AGREEMENT**

During the performance of this contract, the contractor/consultant, for itself, its assignees and successors in interest (hereinafter referred to as the "contractor") agrees as follows:

1. Compliance with Regulations

The contractor shall comply with the Regulations relative to non-discrimination in federally assisted programs of United States Department of Transportation (USDOT), Title 49, Code of Federal Regulations, part 21, as they may be amended from time to time, (hereinafter referred to as the Regulations), which are herein incorporated by reference and made a part of this contract.

2. Non-discrimination

The contractor, with regard to the work performed by it during the contract, shall not discriminate on the grounds of race, color, sex, or national origin in the selection and retention of sub-contractors, including procurement of materials and leases of equipment. The contractor shall not participate either directly or indirectly in the discrimination prohibited by Section 21.5 of the Regulations, including employment practices when the contract covers a program set forth in Appendix B of the Regulations.

3. Solicitations for Sub-contracts, Including Procurement of Materials and Equipment

In all solicitations either by competitive bidding or negotiations made by the contractor for work to be performed under a sub-contract, including procurement of materials or leases of equipment, each potential sub-contractor or supplier shall be notified by the contractor of the contractor's obligations under this contract and the Regulations relative to non-discrimination on the grounds of race, color, sex, or national origin.

4. Information and Reports

The contractor shall provide all information and reports required by the Regulations or directives issued pursuant thereto, and shall permit access to its books, records, accounts, other sources of information, and its facilities as may be determined by the contracting agency or the appropriate federal agency to be pertinent to ascertain compliance with such Regulations, orders and instructions. Where any information required of a contractor is in the exclusive possession of another who fails or refuses to furnish this information, the contractor shall so certify to GDOT or the USDOT as appropriate, and shall set forth what efforts it has made to obtain the information.

5. Sanctions for Non-compliance

In the event of the contractor's non-compliance with the non-discrimination provisions of this contract, the contracting agency shall impose such contract sanctions as it or the USDOT may determine to be appropriate, including, but not limited to:

- Withholding of payments to the contractor under the contract until the contractor complies, and/or;
- Cancellation, termination, or suspension of the contract, in whole or in part

6. Incorporation of Provisions

The contractor shall include the provisions of paragraphs (1) through (5) in every sub-contract, including procurement of materials and leases of equipment, unless exempt by the Regulations, or directives issued pursuant thereto. The contractor shall take such action with respect to any sub-contractor or procurement as the contracting agency or USDOT may direct as a means of enforcing such provisions including sanctions for non-compliance.

Provided, however, that in the event a contractor becomes involved in, or is threatened with, litigation with a sub-contractor or supplier as a result of such direction, the contractor may request GDOT enter into such litigation to protect the interests of the state and, in addition, the contractor may request the USDOT enter into such litigation to protect the interests of the United States.

CONTRACTOR_____

BY_____

BY_____

ATTEST_____

Address for giving notices:

License

CORPORATE SEAL

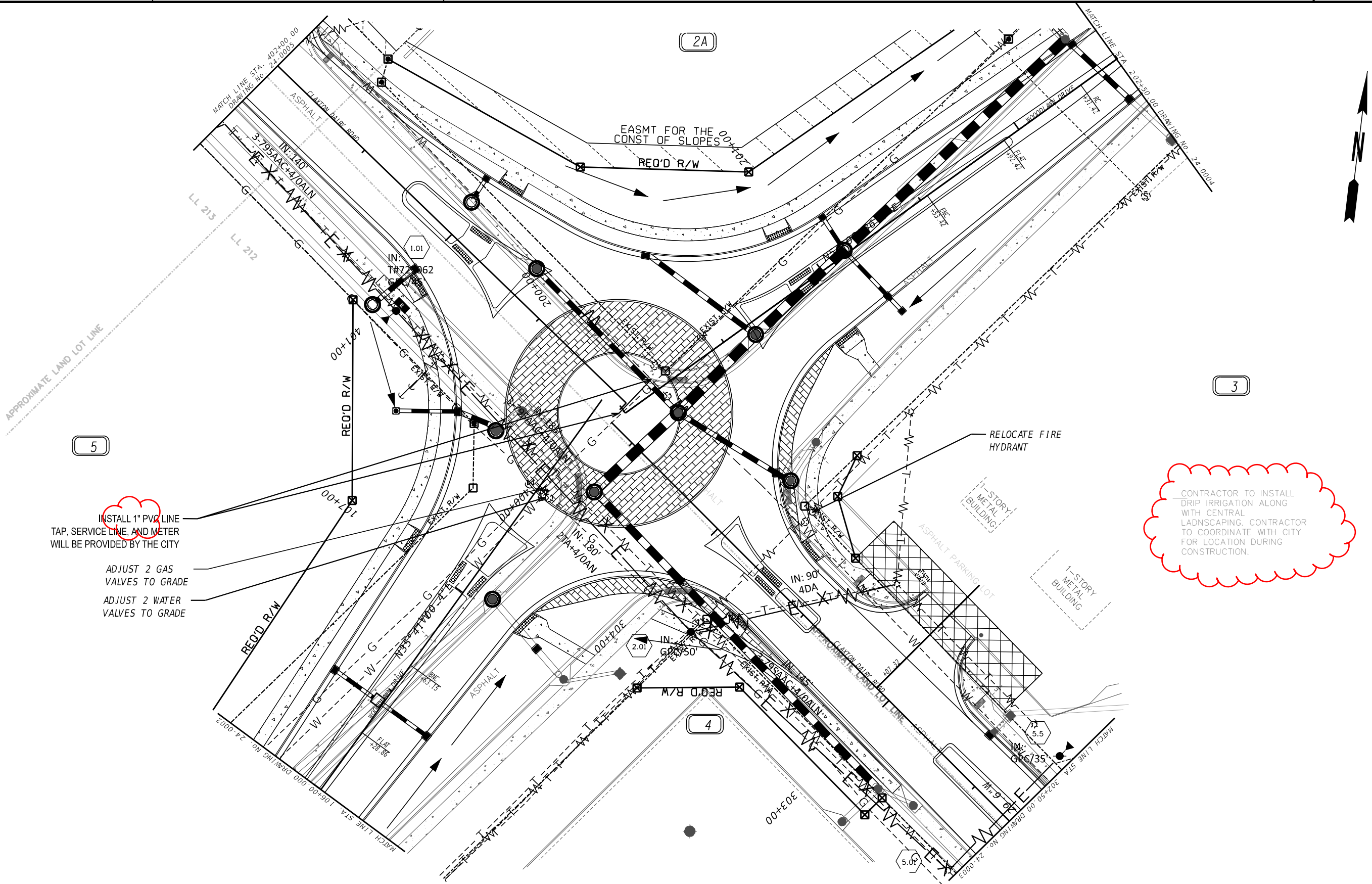

PROPERTY AND EXISTING R/W LINE

REQUIRED R/W LINE

CONSTRUCTION LIMITS

EASEMENT FOR CONSTR & MAINTENANCE OF SLOPES

EASEMENT FOR CONSTR OF SLOPES

EASEMENT FOR CONSTR OF DRIVES

BEGIN LIMIT OF ACCESS.....BLA

END LIMIT OF ACCESS.....ELA

EXISTING LIMIT OF ACCESS

REQ'D LIMIT OF ACCESS

EXISTING LIMIT OF ACCESS & R/W

REQ'D LIMIT OF ACCESS & R/W

ORANGE BARRIER FENCE

ESA - ENV. SENSITIVE AREA

CITY OF DUBLIN

THOMAS & HUTTON

50 Park of Commerce Way • Savannah, GA 31405 • 912.234.5300

www.thomasandhutton.com

SCALE IN FEET

0

20

40

80

REVISION DATES

2026-01-27

UTILITY PLANS

WOODLAWN AND CLAXTON DAIRY

ROUNDBOUT

CHECKED:

BACKCHECKED:

CORRECTED:

VERIFIED:

DATE:

DATE:

DATE:

DATE:

DRAWING No.

24-0001

GPLN-CE
11/05/2020

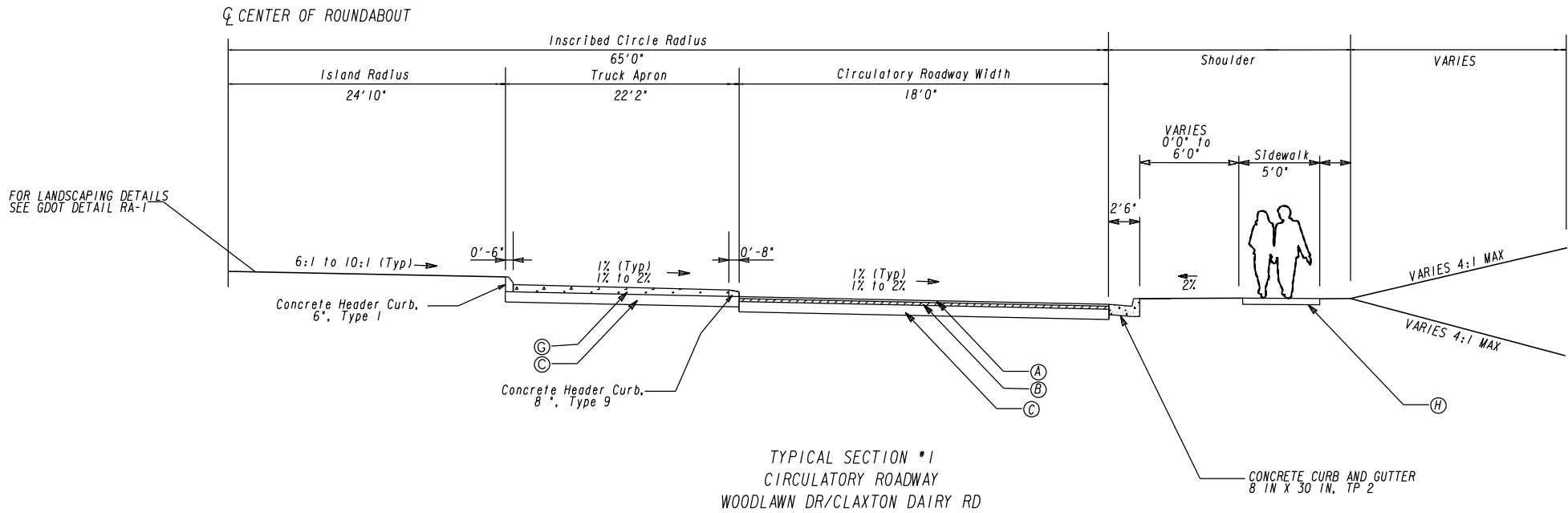

TYPICAL SECTION #1
CIRCULATORY ROADWAY
WOODLAWN DR/CLAXTON DAIRY RD

NOT TO SCALE

STA. 107+33.17 to STA. 107+98.07
STA. 200+00.00 to STA. 200+64.22

STA. 303+95.70 to STA. 304+62.17
STA. 400+00.00 to STA. 400+66.14

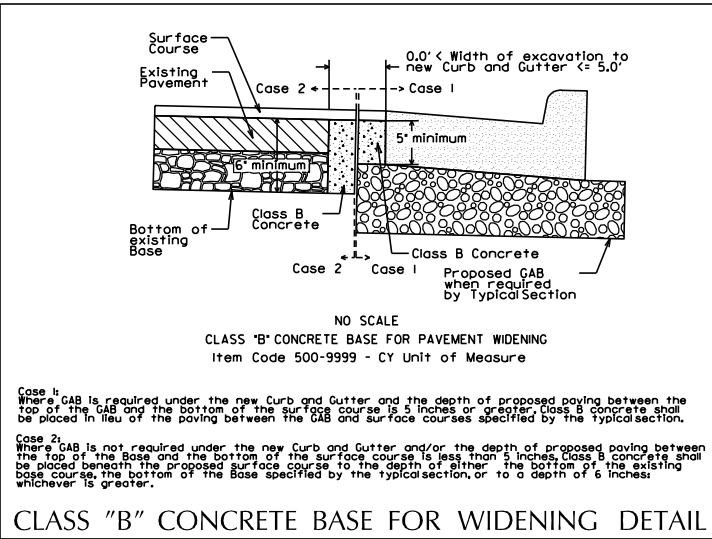

CLASS "B" CONCRETE BASE FOR WIDENING DETAIL

NOTES:

- TYPICAL SECTIONS ILLUSTRATING SUPERELEVATION AND TURN LANES ALSO APPLY TO OPPOSITE-HAND SECTIONS. SEE PLANS FOR LOCATION, DIRECTION AND COMPLETE DETAILS OF EACH.
- SEE ROADWAY PLANS FOR METHOD OF SUPERELEVATION, SUPERELEVATION RATES AND TRANSITIONS, AND LOCATIONS OF NORMAL CROWN AND S.E. SECTIONS.
- MILLING WILL BE REQUIRED TO CREATE A SMOOTH TIE TO THE EXISTING PAVEMENT.
- CENTRAL ISLAND RADIUS VARIES.

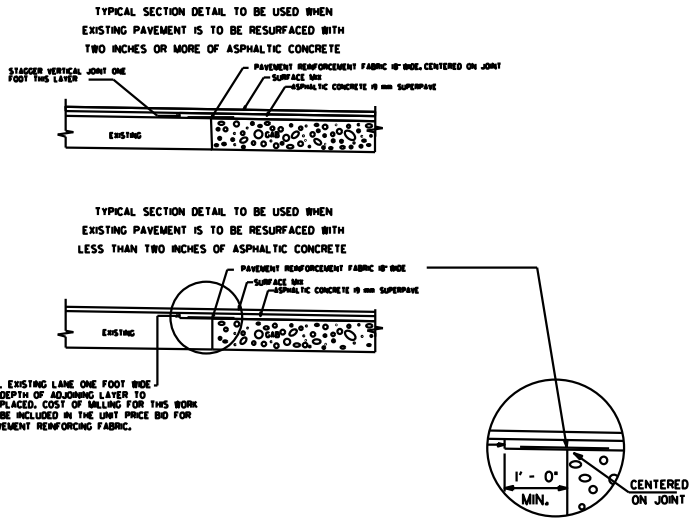

- (A) RECYCLED ASPH CONC 12.5 MM SUPERPAVE, GP 2 ONLY, INCL BITUM MATL & H LIME (165 LB/SY)
- (B) RECYCLED ASPH CONC 19 MM SUPERPAVE, GP 1 OR 2 ONLY, INCL BITUM MATL & H LIME (220 LB/SY)
- (C) GRADED AGGREGATE BASE COURSE, INCL MATL 8 INCH DEPTH
- (D) MILL ASPH CONC PVMT, 1 1/2 IN DEPTH (AS REQUIRED)
- (E) RECYCLED ASP CON LEVELING, INCL BITUM MATL & H LIME, AS NEEDED
- (F) PAVEMENT REINFORCED FABRIC STRIPS, TP 2, 18" WIDTH
- (G) PLAIN PC CONC PVMT, CL 3 CONC, 10 IN THK (COLORED INSIGNIA RED 31136 AND STAMPED)
- (H) CONCRETE SIDEWALK, 4 IN
- (I) 6 IN RAISED CONCRETE MEDIAN



THOMAS & HUTTON
50 Park of Commerce Way •
Savannah, GA 31405 • 912.234.5300
www.thomasandhutton.com

REVISION DATES

| | | | |
|------------|--|--|--|
| 2026-01-27 | | | |
| | | | |
| | | | |
| | | | |
| | | | |
| | | | |

TYPICAL SECTIONS
WOODLAWN AND CLAXTON DAIRY
ROUNDABOUT

| | | | | |
|--------------|--|-------|--|--------------|
| CHECKED: | | DATE: | | DRAWING No.: |
| BACKCHECKED: | | DATE: | | |
| CORRECTED: | | DATE: | | |
| VERIFIED: | | DATE: | | |

05-0001

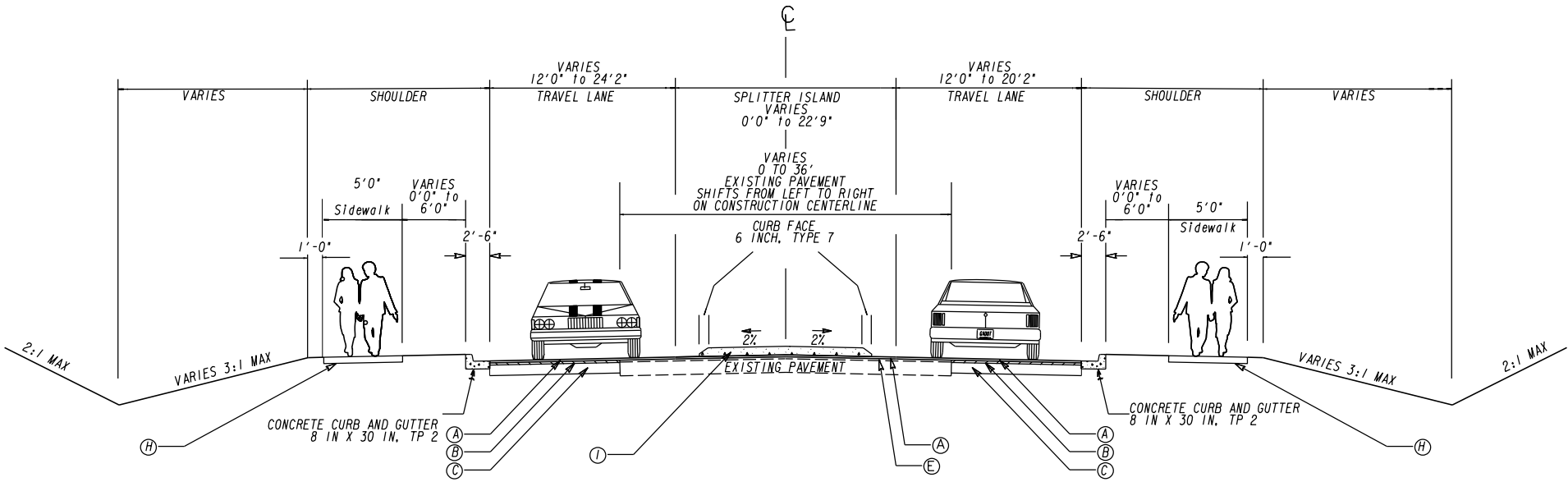

NOTE: EXISITNG SIDEWALK TO REMAIN ON THIS SIDE STA.
104+37.62 TO 105+26.85
200+65.23 TO 204+59.99
300+23.78 TO 303+56.98
400+88.56 TO 401+95.11

TYPICAL SECTION #2
WIDENING & FULL DEPTH ASPHALT
TANGENT SECTION
WOODLAWN DR/CLAXTON DAIRY RD
NOT to SCALE
STA. 105+39.75 to STA. 107+33.17
STA. 200+64.22 to STA. 201+95.16
STA. 301+20.29 to STA. 302+69.20
STA. 303+44.21 to STA. 303+95.70
STA. 400+66.14 to STA. 401+25.49

NOTE: EXISITNG SIDEWALK TO REMAIN ON THIS SIDE STA.
104+33.90 TO 107+34.80
300+23.56 TO 303+49.45
402+52.72 TO 403+63.70

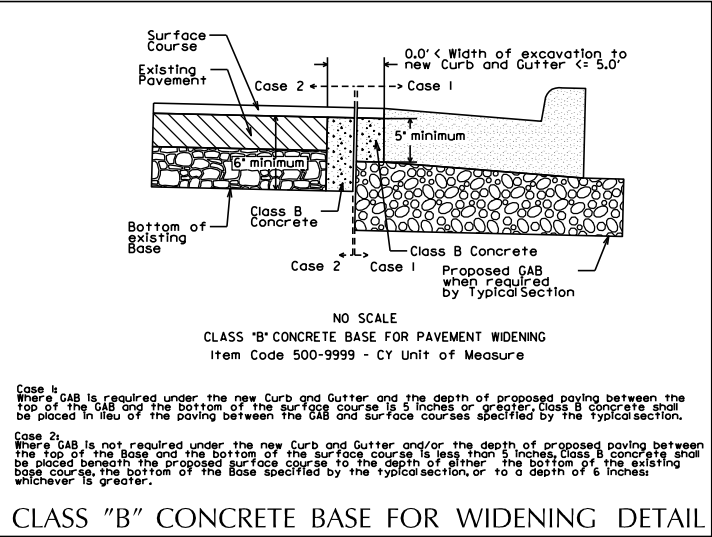

NOTES:

1. TYPICAL SECTIONS ILLUSTRATING SUPERELEVATION AND TURN LANES ALSO APPLY TO OPPOSITE-HAND SECTIONS. SEE PLANS FOR LOCATION, DIRECTION AND COMPLETE DETAILS OF EACH.
2. SEE ROADWAY PLANS FOR METHOD OF SUPERELEVATION, SUPERELEVATION RATES AND TRANSITIONS, AND LOCATIONS OF NORMAL CROWN AND S.E. SECTIONS.
3. MILLING WILL BE REQUIRED TO CREATE A SMOOTH TIE TO THE EXISTING PAVEMENT.

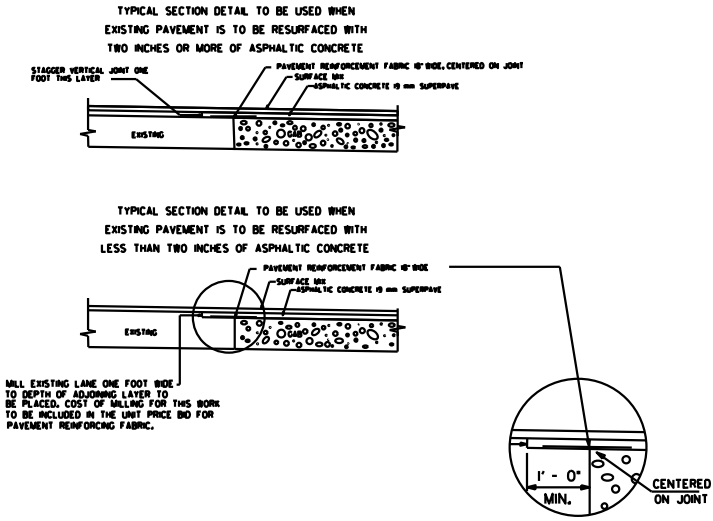

- (A) RECYCLED ASPH CONC 12.5 MM SUPERPAVE, GP 2 ONLY, INCL BITUM MATL & H LIME (165 LB/SY)
- (B) RECYCLED ASPH CONC 19 MM SUPERPAVE, GP 1 OR 2 ONLY, INCL BITUM MATL & H LIME (220 LB/SY)
- (C) GRADED AGGREGATE BASE COURSE, INCL MATL 8 INCH DEPTH
- (D) MILL ASPH CONC PVMT, 1 1/2 IN DEPTH (AS REQUIRED)
- (E) RECYCLED ASP CON LEVELING, INCL BITUM MATL & H LIME, AS NEEDED
- (F) PAVEMENT REINFORCED FABRIC STRIPS, TP 2, 18" WIDTH
- (G) PLAIN PC CONC PVMT, CL 3 CONC, 10 IN THK (COLORED INSIGNIA RED 31136 AND STAMPED)
- (H) CONCRETE SIDEWALK, 4 IN
- (I) 6 IN RAISED CONCRETE MEDIAN



THOMAS & HUTTON
50 Park of Commerce Way •
Savannah, GA 31405 • 912.234.5300
www.thomasandhutton.com

REVISION DATES

| | | | |
|------------|--|--|--|
| 2026-01-27 | | | |
| | | | |
| | | | |
| | | | |
| | | | |
| | | | |
| | | | |

TYPICAL SECTIONS
WOODLAWN AND CLAXTON DAIRY
ROUNDAABOUT

| | | | | |
|--------------|--|-------|--|--------------|
| CHECKED: | | DATE: | | DRAWING No.: |
| BACKCHECKED: | | DATE: | | |
| CORRECTED: | | DATE: | | |
| VERIFIED: | | DATE: | | |

05-0002

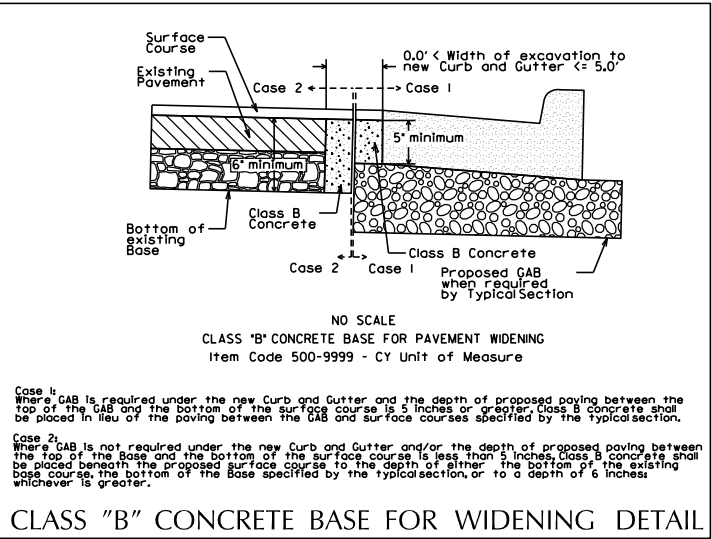
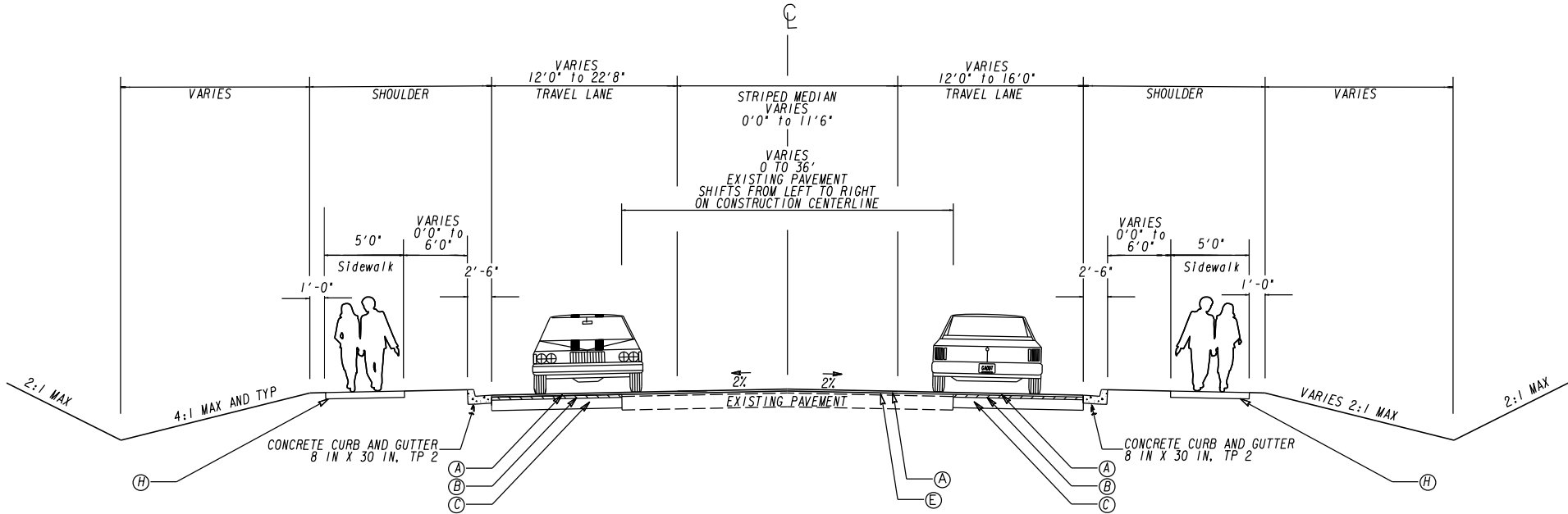

NOTE: EXISTING SIDEWALK TO REMAIN ON THIS SIDE STA.
104+37.62 TO 105+26.85
200+65.23 TO 204+59.99
300+23.78 TO 303+56.98
400+88.56 TO 401+95.11

TYPICAL SECTION #3
WIDENING & FULL DEPTH ASPHALT
TANGENT SECTION
WOODLAWN DR/CLAXTON DAIRY RD
NOT TO SCALE
STA. 104+33.73 TO STA. 105+39.75
STA. 201+95.16 TO STA. 204+59.99
STA. 300+23.78 TO STA. 301+20.29
STA. 302+69.20 TO STA. 303+44.21
STA. 401+25.49 TO STA. 403+63.70

NOTE: EXISTING SIDEWALK TO REMAIN ON THIS SIDE STA.
104+33.90 TO 107+34.80
300+23.56 TO 303+49.45
402+52.72 TO 403+63.70

NOTES:

1. TYPICAL SECTIONS ILLUSTRATING SUPERELEVATION AND TURN LANES ALSO APPLY TO OPPOSITE-HAND SECTIONS. SEE PLANS FOR LOCATION, DIRECTION AND COMPLETE DETAILS OF EACH.
2. SEE ROADWAY PLANS FOR METHOD OF SUPERELEVATION, SUPERELEVATION RATES AND TRANSITIONS, AND LOCATIONS OF NORMAL CROWN AND S.E. SECTIONS.
3. MILLING WILL BE REQUIRED TO CREATE A SMOOTH TIE TO THE EXISTING PAVEMENT.

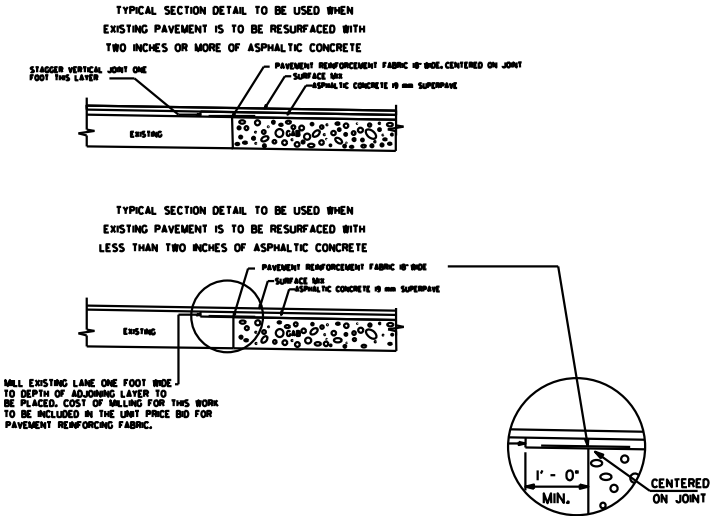

- Ⓐ RECYCLED ASPH CONC 12.5 MM SUPERPAVE, GP 2 ONLY, INCL BITUM MATL & H LIME (165 LB/SY)
- Ⓑ RECYCLED ASPH CONC 19 MM SUPERPAVE, GP 1 OR 2 ONLY, INCL BITUM MATL & H LIME (220 LB/SY)
- Ⓒ GRADED AGGREGATE BASE COURSE, INCL MATL 8 INCH DEPTH
- Ⓓ MILL ASPH CONC PVMT, 1 1/2 IN DEPTH (AS REQUIRED)
- Ⓔ RECYCLED ASP CON LEVELING, INCL BITUM MATL & H LIME, AS NEEDED
- Ⓕ PAVEMENT REINFORCED FABRIC STRIPS, TP 2, 18" WIDTH
- Ⓖ PLAIN PC CONC PVMT, CL 3 CONC, 10 IN THK (COLORED INSIGNIA RED 31136 AND STAMPED)
- Ⓗ CONCRETE SIDEWALK, 4 IN
- Ⓘ 6 IN RAISED CONCRETE MEDIAN



THOMAS & HUTTON
50 Park of Commerce Way •
Savannah, GA 31405 • 912.234.5300
www.thomasandhutton.com

REVISION DATES

| | | | |
|------------|--|--|--|
| 2026-01-27 | | | |
| | | | |
| | | | |
| | | | |
| | | | |
| | | | |
| | | | |
| | | | |

TYPICAL SECTIONS
WOODLAWN AND CLAXTON DAIRY
ROUNDBOUT

| | | | | |
|--------------|--|-------|--|--------------|
| CHECKED: | | DATE: | | DRAWING No.: |
| BACKCHECKED: | | DATE: | | |
| CORRECTED: | | DATE: | | |
| VERIFIED: | | DATE: | | |

05-0003

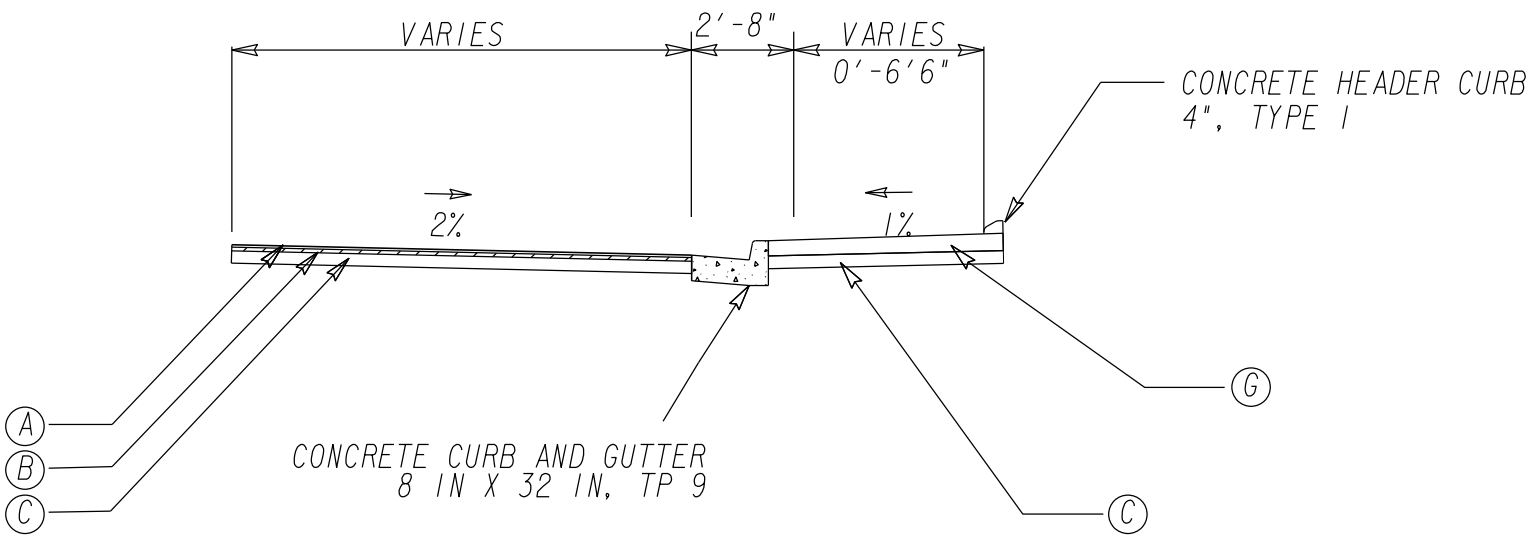

OUTSIDE TRUCK APRON
TYPICAL SECTION
NOT TO SCALE

* SEE SHEET 13-0001 FOR LOCATION DETAILS

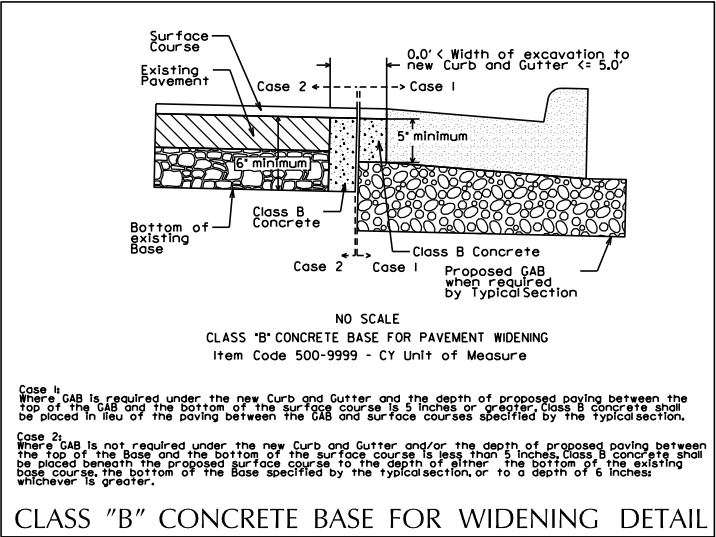

- Ⓐ RECYCLED ASPH CONC 12.5 MM SUPERPAVE, GP 2 ONLY, INCL BITUM MATL & H LIME (165 LB/SY)
- Ⓑ RECYCLED ASPH CONC 19 MM SUPERPAVE, GP 1 OR 2 ONLY, INCL BITUM MATL & H LIME (220 LB/SY)
- Ⓒ GRADED AGGREGATE BASE COURSE, INCL MATL 8 INCH DEPTH
- Ⓓ MILL ASPH CONC PVMT, 1 1/2 IN DEPTH (AS REQUIRED)
- Ⓔ RECYCLED ASP CON LEVELING, INCL BITUM MATL & H LIME, AS NEEDED
- Ⓕ PAVEMENT REINFORCED FABRIC STRIPS, TP 2, 18" WIDTH
- Ⓖ PLAIN PC CONC PVMT, CL 3 CONC, 10 IN THK (COLORED INSIGNIA RED 31136 AND STAMPED)
- Ⓗ CONCRETE SIDEWALK, 4 IN
- Ⓘ 6 IN RAISED CONCRETE MEDIAN



THOMAS & HUTTON
50 Park of Commerce Way •
Savannah, GA 31405 • 912.234.5300
www.thomasandhutton.com

REVISION DATES

| | | |
|------------|--|--|
| 2026-01-27 | | |
| | | |
| | | |
| | | |
| | | |
| | | |
| | | |
| | | |

TYPICAL SECTIONS
WOODLAWN AND CLAXTON DAIRY
ROUNDBOUT

| | | | | |
|--------------|--|-------|--|--------------|
| CHECKED: | | DATE: | | DRAWING No.: |
| BACKCHECKED: | | DATE: | | |
| CORRECTED: | | DATE: | | |
| VERIFIED: | | DATE: | | |

05-0004